

These particulars are believed to be accurate but they are not guaranteed and do not form a contract. Neither Jordan Fishwick nor the vendor or lessor accept any responsibility in respect of these particulars, which are not intended to be statements or representations of fact and any intending purchaser or lessee must satisfy himself by inspection or otherwise as to the correctness of each of the statements contained in these particulars. Any floorplans on this brochure are for illustrative purposes only and are not necessarily to scale.

While every attempt has been made to ensure the accuracy of the floorplan contained here, measurements of doors, windows, rooms and other items are approximate and no responsibility is taken for any error or omission of this document. This plan is for illustrative purposes only and should be used as such by any prospective purchaser. The services, systems and appliances shown have not been tested and no guarantee as to their operability or efficiency can be given. Made with Metropack 5/2025

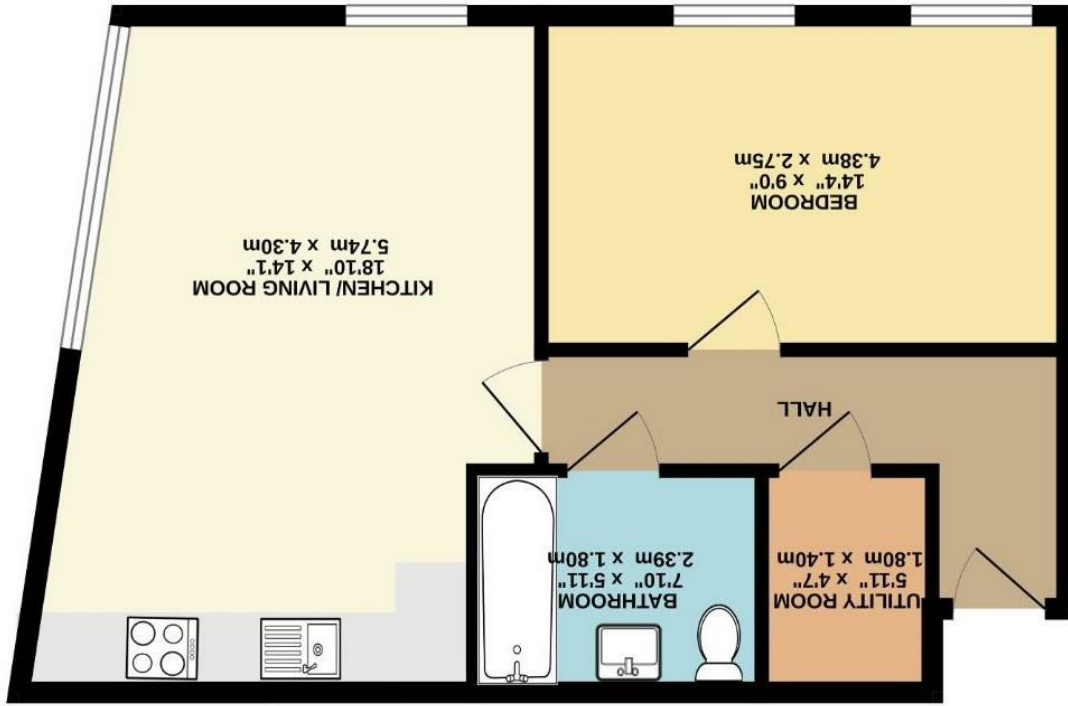

GROUND FLOOR  
516 sq.ft. (47.9 sq.m.) approx.





**Brown Street Altrincham WA14 2ET**

**£92,750**



### The Property

**\*Shared Ownership\*** A superbly located first floor apartment within a purpose built development positioned on one of the popular 'B Streets', available on a shared ownership basis, which is ideal for a first time buyer. The vendors currently own 35%, however you can purchase a larger share or buy the property outright.

The property comprises; Communal Entrance. Communal Hall. Entrance Hall. Open Plan Living Room and Dining Kitchen. Bedroom. Bathroom. Large Store.

In order to sell as shared ownership (currently 35%) the applicant must:

1. Pass affordability with Metro Finance (up to 45% of net income)
2. Be a household not to be earning more than £80,000pa gross
3. Must not own another property
4. Be intending to live in the property as their principal home

There is no requirement for shared owners to be first time buyers or similar. The shared ownership lease is 125 years from 6.9.22, so 122 years remaining. The current rent is as follows:

Rent £466.04 pcm

### Directions

WA14 2ET



- Shared ownership or purchase outright
- Leasehold - 246 years remaining
- Ground Rent £0
- Service Charge £168.31 pcm
- Undercroft parking available subject to permit application.
- Flexible shared ownership % available
- No chain
- Central location of Hale village
- Walking distance to Altrincham Town Centre
- Close to amenities and transport links

**Postcode - WA14 2ET**

**EPC Rating - B**

**Floor Area - 516.00 sq ft**

**Local Authority - Trafford**

**Council Tax - B**

